

Soils Map

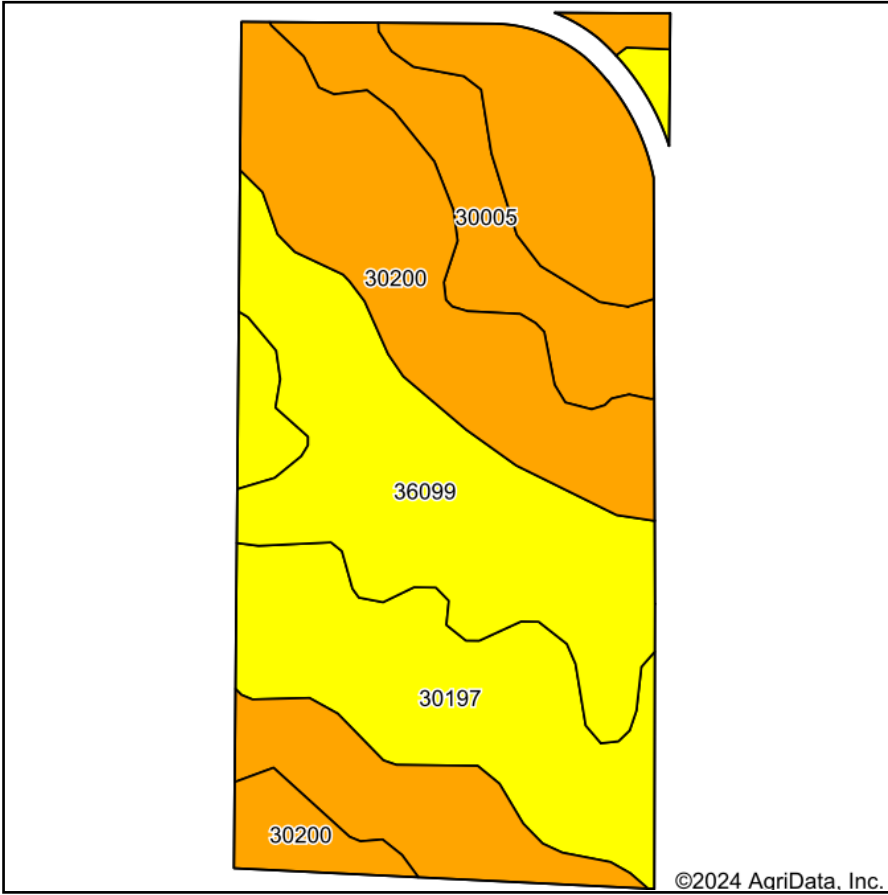

Soils data provided by USDA and NRCS.

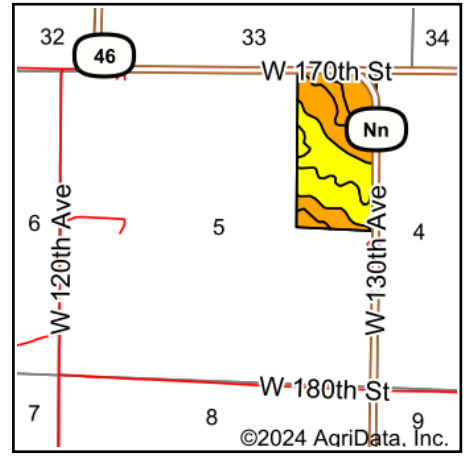

State: **Missouri**
 County: **Harrison**
 Location: **5-65N-29W**
 Township: **Washington**
 Acres: **75.2**

Growthland

Maps Provided By:



Area Symbol: MO081, Soil Area Version: 27

Code	Soil Description	Acres	Percent of field	NCCPI Overall Legend	*n NCCPI Overall	*n NCCPI Corn	*n NCCPI Soybeans
30200	Shelby loam, 9 to 14 percent slopes	25.70	34.2%		72	72	61
36099	Zook-Colo silty clay loams, 1 to 3 percent slopes, frequently flooded	19.24	25.6%		67	67	57
30197	Shelby loam, 14 to 18 percent slopes	15.95	21.2%		65	65	56
30005	Adair loam, 3 to 9 percent slopes	14.31	19.0%		72	72	62
Weighted Average					*n 69.2	*n 69.2	*n 59.1

*n: The aggregation method is "Weighted Average using all components"