

Tillable CSR2 Map

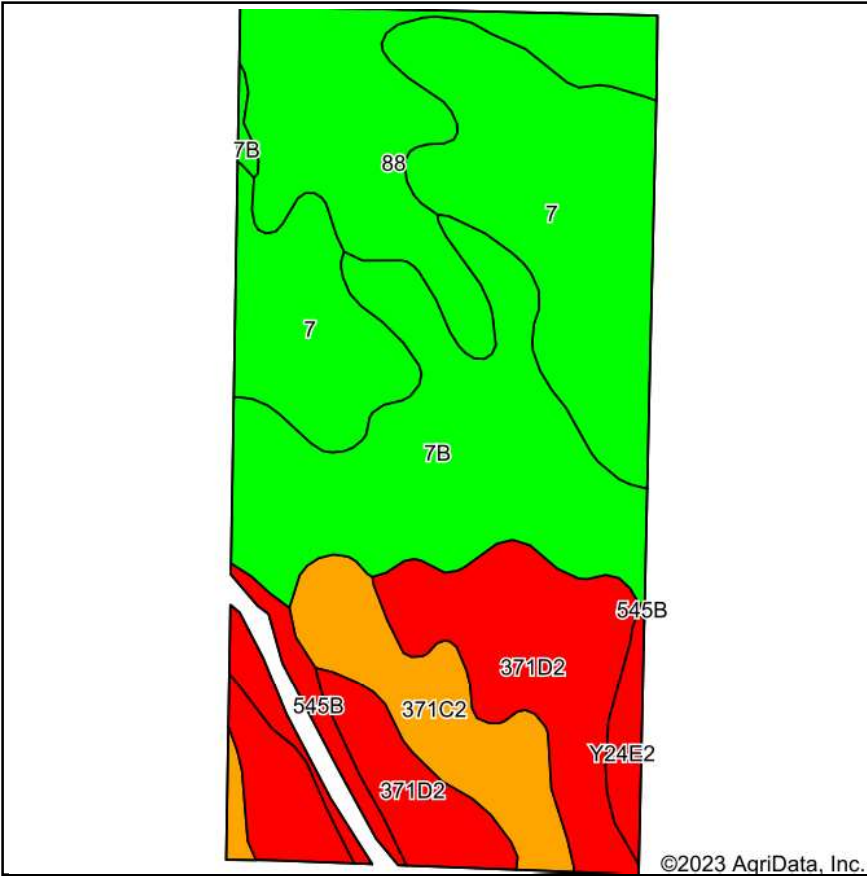

Soils data provided by USDA and NRCS.

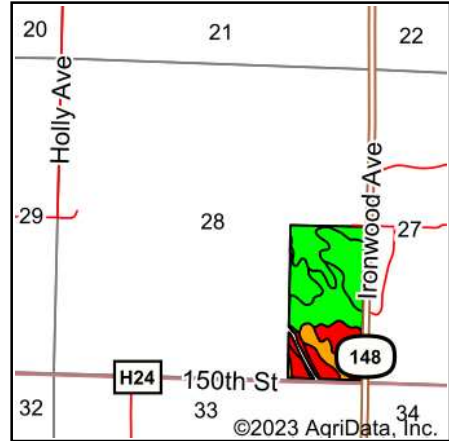

State: **Iowa**
 County: **Adams**
 Location: **28-73N-34W**
 Township: **Washington**
 Acres: **73.43**

Growthland

Maps Provided By:
surety
CUSTOMIZED ONLINE MAPPING
 © AgriData, Inc. 2023 www.AgriDataInc.com



| Area Symbol: IA003, Soil Area Version: 34 | | | | | |
|---|---|-------|------------------|-------------------------|-------------|
| Code | Soil Description | Acres | Percent of field | CSR2 Legend | CSR2** |
| 7 | Wiota silty clay loam, 0 to 2 percent slopes, rarely flooded | 20.30 | 27.6% | | 99 |
| 7B | Wiota silty clay loam, 2 to 5 percent slopes, rarely flooded | 16.96 | 23.1% | | 95 |
| 371D2 | Sharpsburg-Nira silty clay loams, 9 to 14 percent slopes, eroded | 14.14 | 19.3% | | 57 |
| 88 | Nevin silty clay loam, 0 to 2 percent slopes, rarely flooded | 11.57 | 15.8% | | 95 |
| 371C2 | Sharpsburg-Nira silty clay loams, 5 to 9 percent slopes, eroded | 6.84 | 9.3% | | 83 |
| 545B | Zook-Ely-Gullied land complex, 2 to 5 percent slopes | 2.35 | 3.2% | | 64 |
| Y24E2 | Shelby clay loam, dissected till plain, 14 to 18 percent slopes, eroded | 1.27 | 1.7% | | 35 |
| | | | | Weighted Average | 85.6 |

**IA has updated the CSR values for each county to CSR2.
 Soils data provided by USDA and NRCS.

DISCLAIMER: All information contained in this document has been provided by the subject company to Growthland and, while believed to be correct, has not been verified. Accordingly, Growthland makes no representations or warranties as to the accuracy and truthfulness of such information. The recipient hereof acknowledges that Growthland shall not be liable for any loss or injury suffered by said recipient in any way connected to the delivery by Growthland of this document.